

This product be applicable to: iPhone, iPod touch, iPad

UDIRC

INSTRUCTION MANUAL

NO.U809A
NO.U810A

PACK LIST

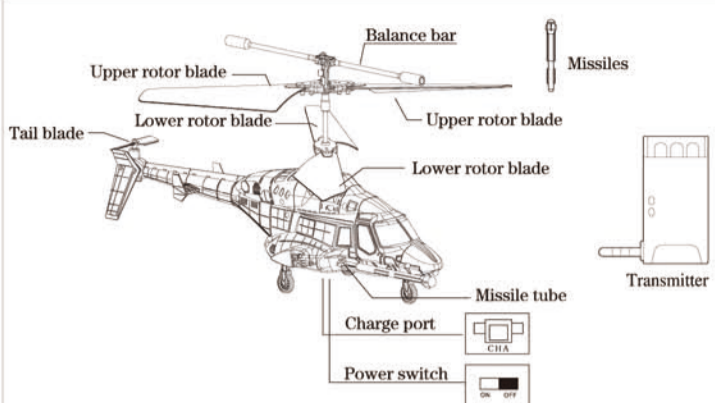

-1-

Operation step

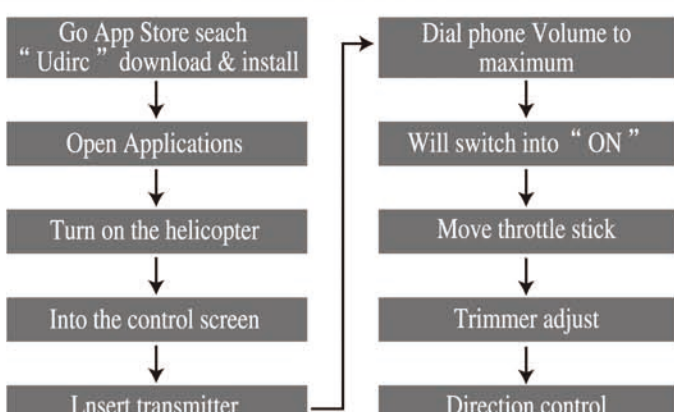

Control screen

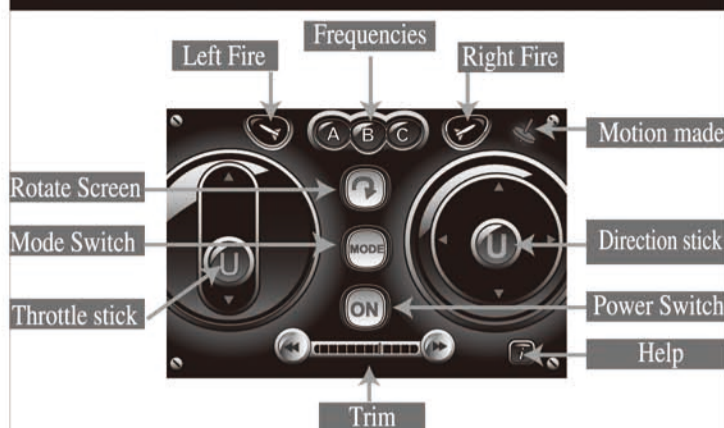

-2-

Function details

1. Frequencies

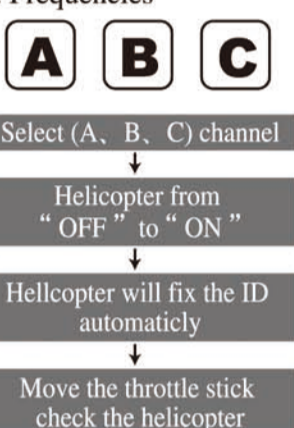

2. Mode motion

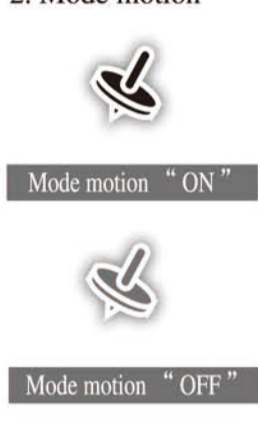

3. Trim

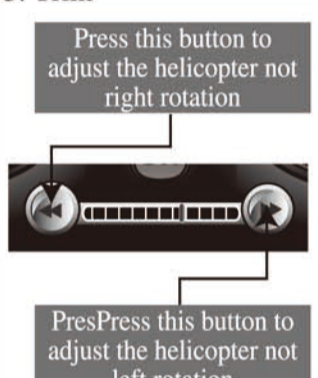

4. Switch



-3-

Charging Transmitter

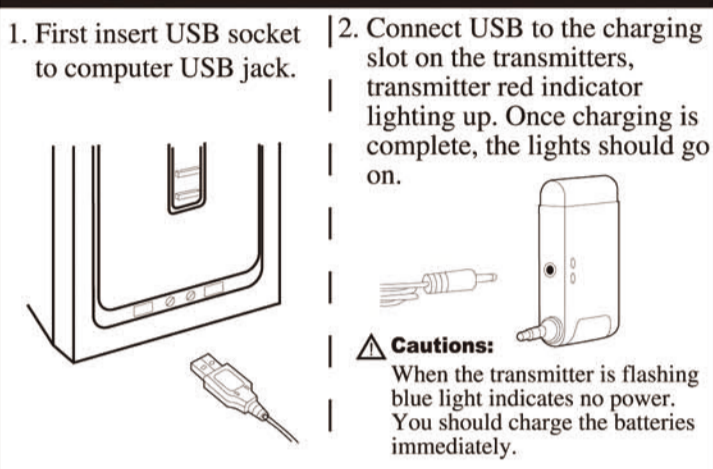

Charging Helicopter

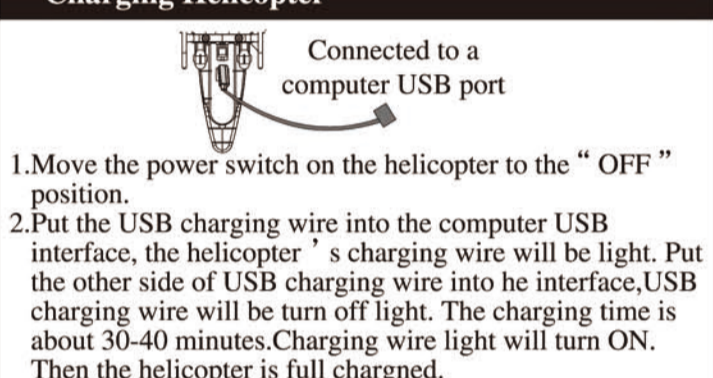

-4-

Loading missiles

1. Make sure missile key is aligned with launch tube keyway. slide missile into launch tube until a click is heard or felt the missile should latch into place.
2. Repeat for other side.

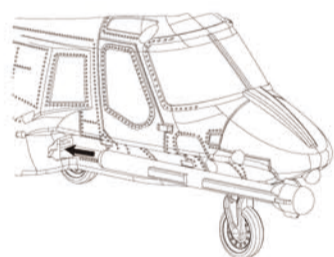

Launching missiles

Press the left button of the screen the missile on the left side of the helicopter launched. press the button on the right side of the screen, the missile on the right side will also launched!

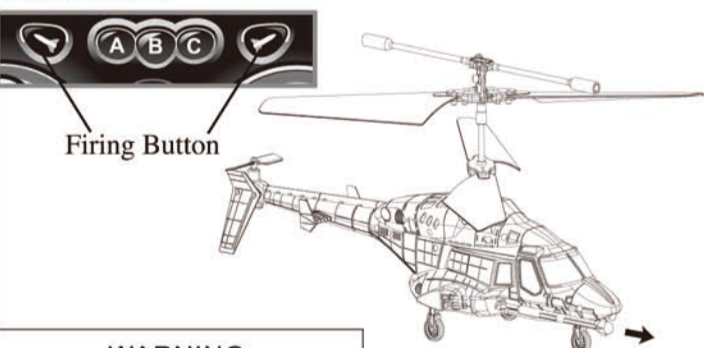

WARNING:
Do not aim at eyes or face.

-5-

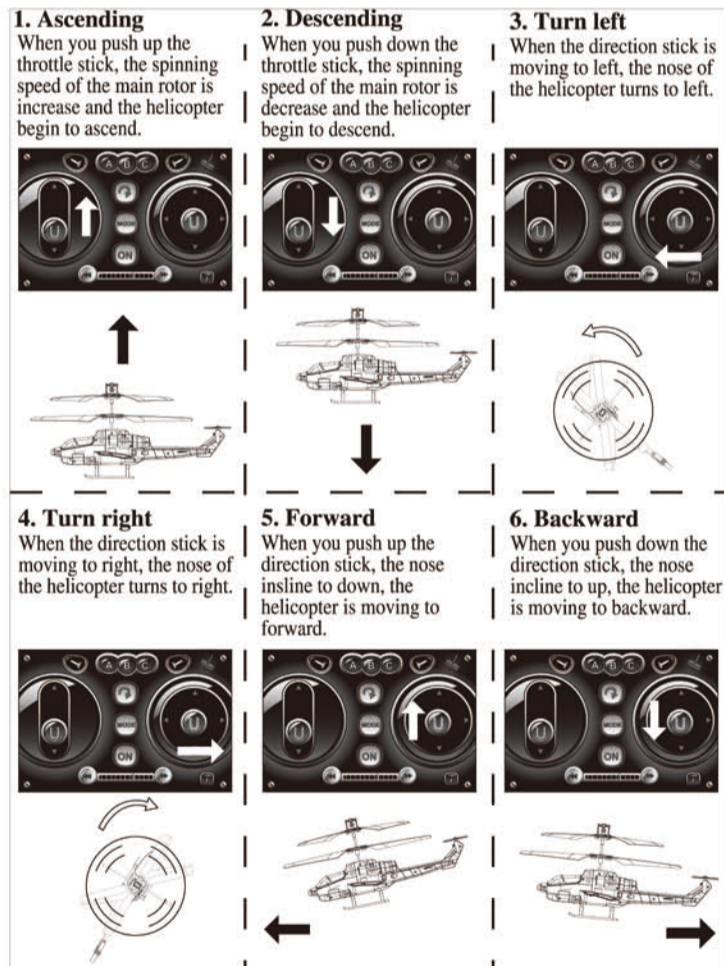

-6-

Motion Mode

Switch to "Motion Mode" control, push up the throttle stick, swing your hands according to the following indicate the direction of helicopter.

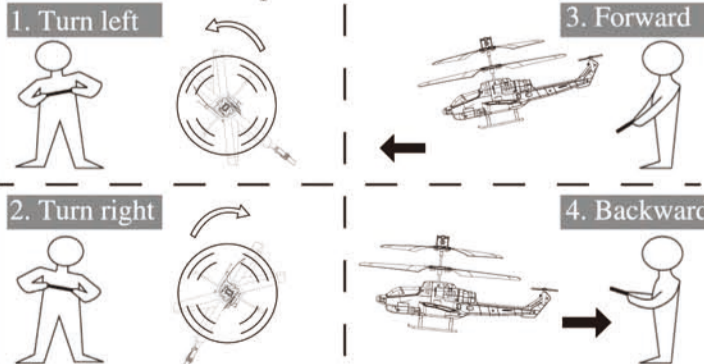

Other notes

- If the helicopter don't response, pls check as below.
- After put the transmitter to earplug, the phone volumn it should be to maximum.
- Check the light whether flashing on the transmitter IR Sender.
- Transmitter power low, need to be charged.
- ID need to be fixed.
- Off all other transmitter IR sender.
- When calls come in, unplug the transmitter can receive calls.

-7-

Support list

- All Apple's product - Iphone, ipod touch, ipad

Cautions

1. When the battery in the transmitter or the helicopter runs low, the control distance will be reduced.
2. The biggest control radius of the helicopter is 6 meters, please uses in 6 meters area, otherwise the helicopter can be out of control when it overstep this area.
3. If the helicopter was damaged, distortion, please repaired in time. Do not fly such as the rotor serious damaged or broken, otherwise it will cause injured.
4. Do not make the helicopter crashing or serious strike from upper air, this may damage the helicopter or reduce the helicopter lift.

Trouble shooting

Symptom	Cause	Correction
Propeller can't move.	• ON/OFF switch is OFF. • Weak battery.	• Set switch to ON. • Re-charge the battery pack.
Suddenly stop and drop down when flying.	• Weak power.	• Re-charge the battery pack.
The helicopter does not react. Lose the control.	• Channel selection on transmitter is not correct. • Another infrared control device using the same channel. • Affected by strong lighting.	• Reset the correct channel. • Avoid these if possible, or choose another place to operate the helicopter. • Change another environment to avoid direct lighting.

-8-